

ITEM	QTY	DESCRIPTION
1	1	CAP
2	2	SCREWS, TOP CAP
3	1	GASKET, TOP CAP
4	1	RING
5	2	SCREW
6	1	JOINT
7	1	E-RING
8	1	SCREW, AIR
9	1	SPRING, AIR SCREW
10	1	O-RING
11	1	WASHER
12	1	SPRING
13	1	NUT
14	1	ADJUSTER
15	1	FLOAT VALVE 2.5
16	1	SCREW
17	1	GASKET, BOWL
18	2	PLATE
19	4	SCREW, BOWL
20	1	O-RING

MK-VM28-418

1986-2001 Suzuki RM 80

Mikuni VM28-418 Carburetor

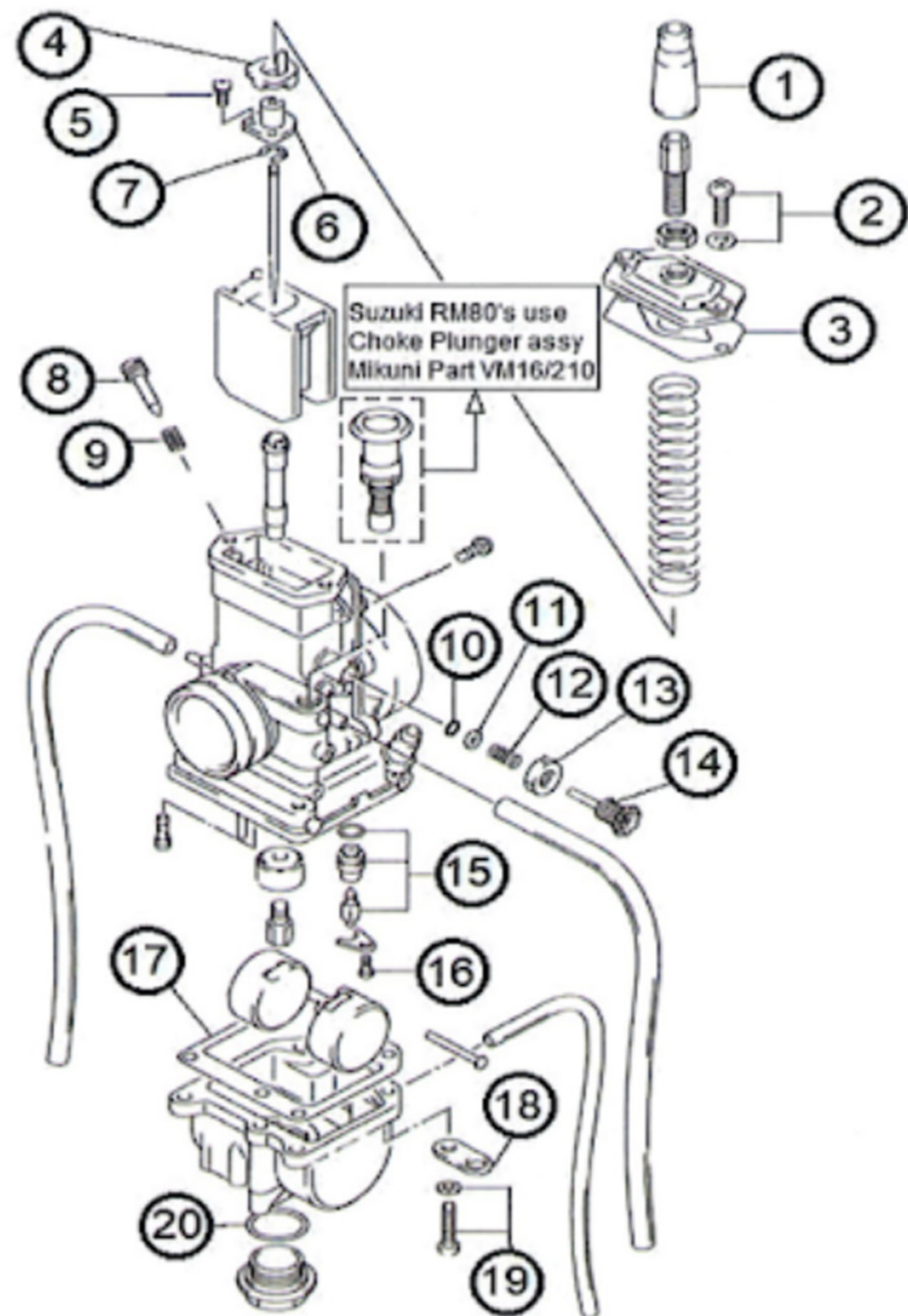

NOTE:

Choke assembly may be Lever Style or Plunger Assembly style

****REPLACEMENT JET NOTE**

Due to varying model requirements, this kit does not include main jets or pilot jets. If needed, refer to the following Mikuni Part numbers when acquiring these jets:

Main Jet: 4/042-XXXX

Pilot Jet: VM22/210-XXXX