

ITEM	QTY	DESCRIPTION
1	2	TOP CAP SCREWS
2	1	DIAPHRAGM ASSY (TOP)
3	1	RING (TOP)
4	1	O-RING (JET NEEDLE)
5	1	SPRING (JET NEEDLE)
6	1	WASHER, THICK (JET NEEDLE)
7	1	E-RING (JET NEEDLE)
8	1	WASHER, THIN (JET NEEDLE)
9	1	THROTTLE COVER O-RING
10	1	AIR CUT-OFF DIAPHRAGM
11	1	AIR CUT-OFF DIAPHRAGM SPRING
12	1	O-RING (NOZLE)
13	1	STARTER CAP O-RING
14	1	FUEL SCREW SET
14	1	FUEL SCREW (ADDITIONAL)
15	1	NEEDLE VALVE SET
16	1	SCREW
17	1	SCREW
18	1	BOWL GASKET
19	3	SCREW (BOWL)
20	1	SCREW (BOWL)
21	1	BOWL DRAIN SCREW

Yamaha ATV Applications:

- 2004-2005 Yamaha YFM Bruin
- 2004-2006 Yamaha YFM350A/FA 2WD/4WD
- 2000-2012 Yamaha YFM 400F Big Bear 4WD
- 2007-2011 Yamaha YFM 350G/FG 2WD/4WD
- 2006-2007 Yamaha YFM350X Wolverine
- 2000-2004 Yamaha YFM 400 Big Bear 2WD
- 2007-2004 Yamaha Grizzly YFM 350
- 2000-2006 Yamaha YFM400FA Kodiak 4WD
- 2007-2008 Yamaha YFM400FG Grizzly
- 2000-2004 Yamaha YFM400FG Kodiak 2WD
- 2006-2008 Yamaha YFM450FX Wolverine
- 2008-2011 Yamaha YFM450FG Grizzly
- 2003-2006 Yamaha YFM450F Kodiak

MK-BSR33 REBUILD KIT

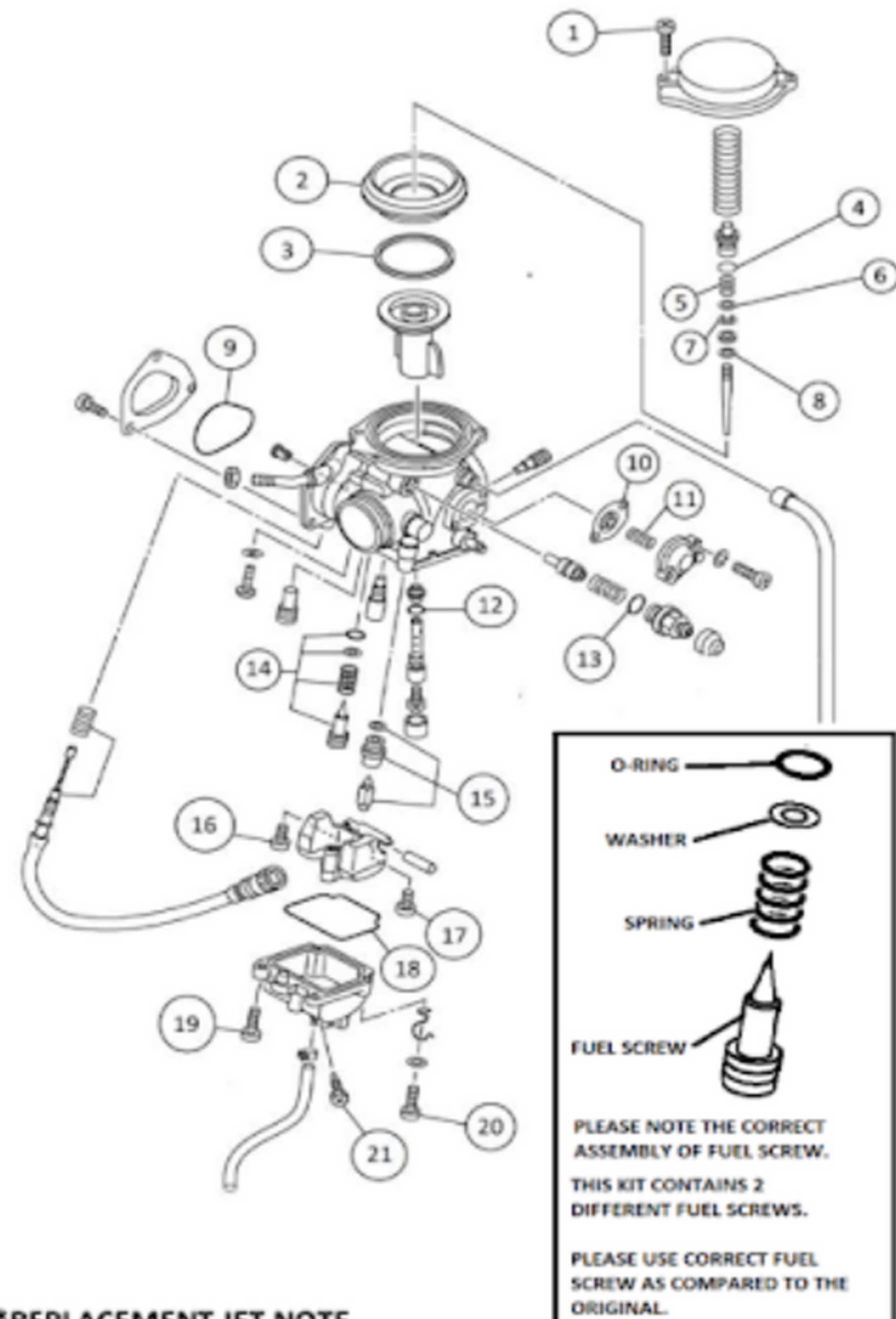

**REPLACEMENT JET NOTE

Due to varying model requirements, this kit does not include main or pilot jets
 If needed, refer to the following Mikuni Part numbers when acquiring these jets:
 Main Jet: N10221-XXXX
 Pilot Jet: N224103-XXXX